

# Sonderfedern

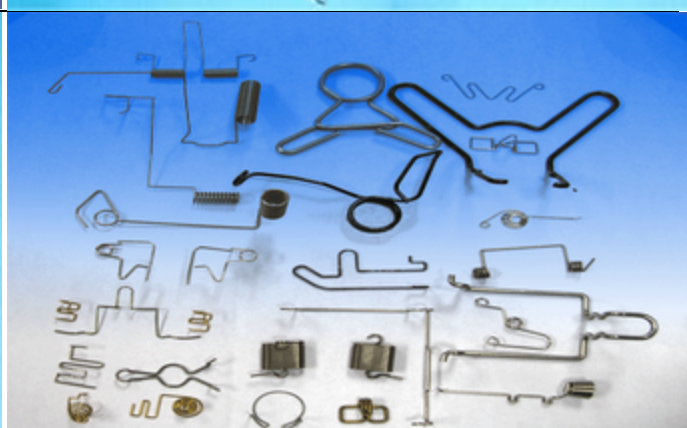

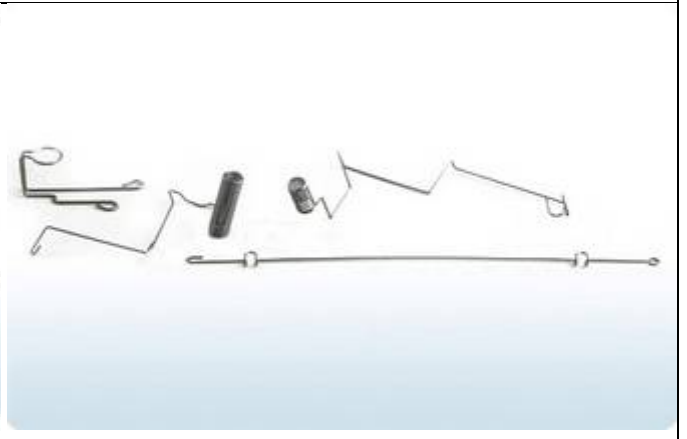
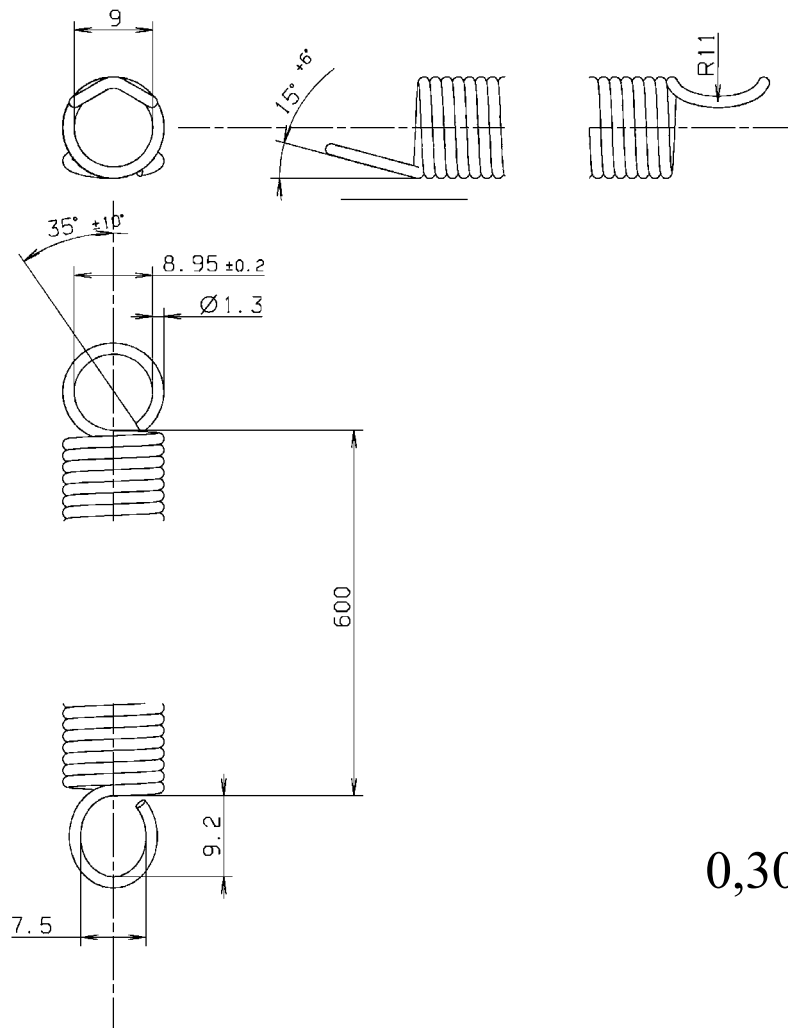

0,30 € / St

					Datum	Name	<b>莫克 7054-7 :</b> <b>回动弹簧</b>	
				bear.				
				gepr.				
				Allg. Toleranzen (TOLERANCES): DIN ISO 2768-mH				
				Werkstoff			Zeichnungsnummer:	Blatt
				EN 10270-1-DH-1,3 ph			AUFWICKELFEDER (RETRACTION SPRING)	
							2711118100	Bl.
Zust.	Änderung	Datum	Name	Masse (kg/St)	0,16		Oberfläche:	

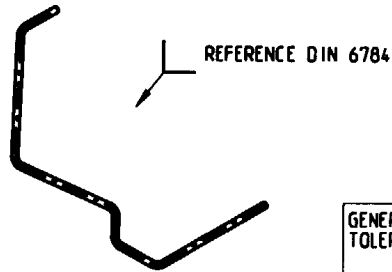
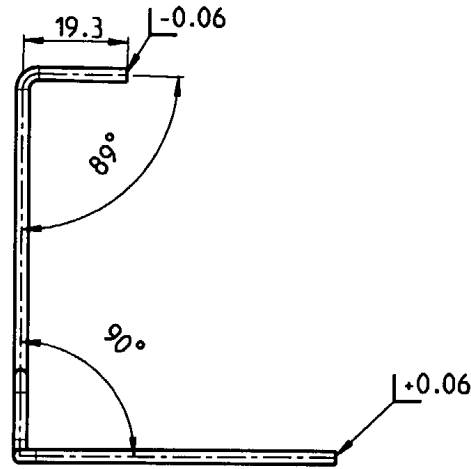
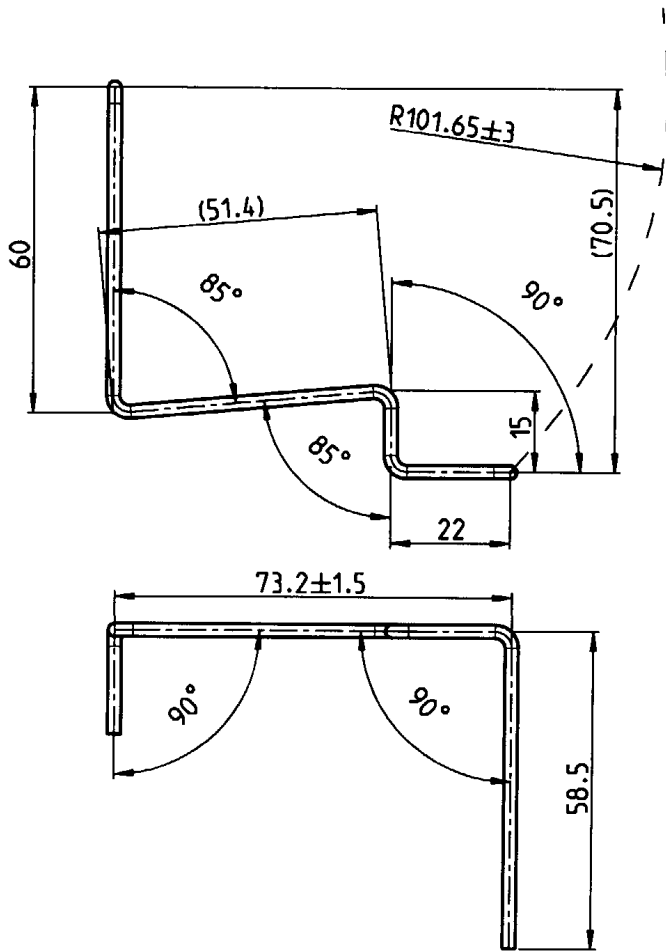

0,02 € / St

NO.	TYPE	XA XE	YA YE	ZA ZE	LENGTH	RADIUS ANGLE	ORIENTATION ANGLE
1	LINE	0.00 0.00	0.00 0.26	0.00 14.99	15.00		
2	CURVE	0.00 0.00	0.26 -3.97	14.99 19.30	6.72	4.23 91.00	
3	LINE	0.00 0.00	-3.97 -55.06	19.30 19.30	51.09		90.00
4	CURVE	0.00 4.60	-55.06 -59.27	19.30 19.30	7.01	4.23 95.00	
5	LINE	4.60 46.60	-59.27 -55.60	19.30 19.30	42.16		180.00
6	CURVE	46.60 51.20	-55.60 -59.81	19.30 19.30	7.01	4.23 95.00	
7	LINE	51.20 51.20	-59.81 -65.96	19.30 19.30	6.15		180.00
8	CURVE	51.20 55.43	-65.96 -70.19	19.30 19.30	6.64	4.23 90.00	
9	LINE	55.43 68.97	-70.19 -70.19	19.30 19.30	13.54		-90.00
10	CURVE	68.97 73.20	-70.19 -70.19	19.30 15.07	6.64	4.23 90.00	
11	LINE	73.20 73.20	-70.19 -70.19	15.07 -39.20	54.27		

PREFORMED LENGTH = 216.25  
INSIDE BEND RADII = R3

GENERAL TOLERANCE	DEVIATION FOR ANGLE ±1°	RANGE OF NOMINAL SIZES / DEVIATIONS								
		OVER	0.5	2.5	6.3	10.0	25.0	63.0	100.0	400.0
		UP TO	2.5	6.3	10.0	25.0	63.0	100.0	400.0	1000.0
			±1	±1	±1	±1	±1	±1	±1	±1

Tolerance for plastic parts VDDN 1.1251.001   
  Auxiliary dimension DIN 406 - 10   
  Theoretical dimension DIN ISO 1101   
 Part edges DIN 6784  
 Statistic tolerancing VDDN 1.1341.010   
  Unfinished dimension DIN 406 - 10   
  Surface quality DIN ISO 1302   
 Tolerances DIN 7167

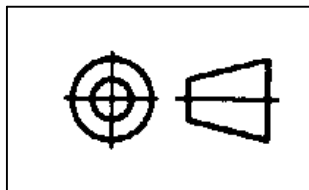

				Datum	Name		
				bear.		<b>莫克 7054-8:</b> <b>镀锌弹簧钢丝杠杆</b>	
				gepr.			
				Allg. Toleranzen: SIEHE ZEICHNUNG			
				Werkstoff VORVERZINKTER FEDERSTAHLDRAHT EN 10270-1-SL-2,45 Z		Zeichnungsnummer: <b>8131113354</b> HEBEL	
Zust.	Änderung	Datum	Name	Masse (kg/St)	0,01	Oberfläche:	
						INDEX C Bl.	



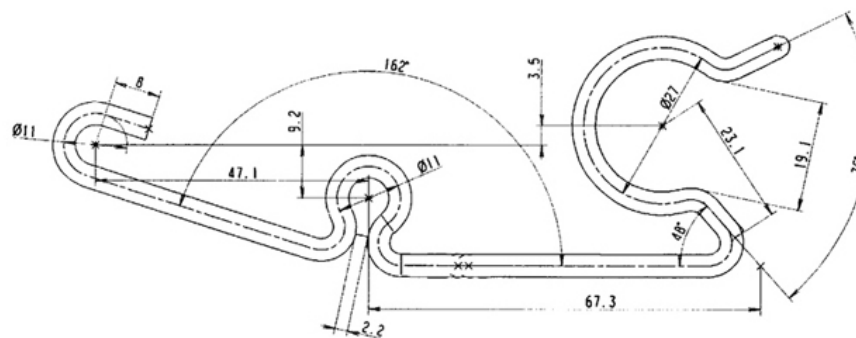
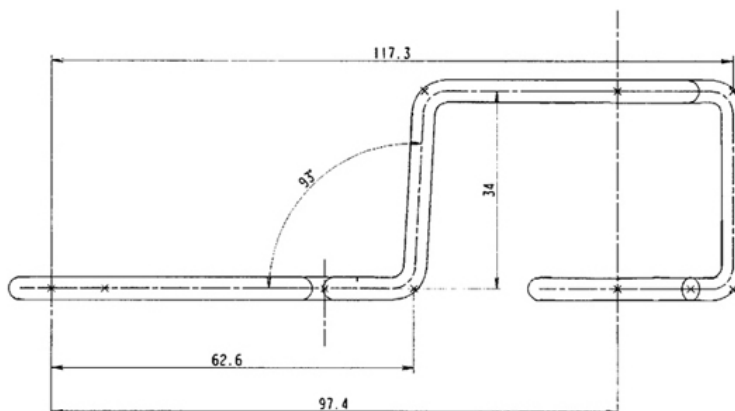

材料：普通钢条 St 37-2

直径：4 mm

扣重量：0.045 公斤

0,15 € / St

> 400 ≤ 1000		
> 120 ≤ 400		
> 30 ≤ 120		
> 6 ≤ 30	±0.5	
≤ 6	±0.2	
Winkel Angle	±1°	
	fertig finished	roh raw
Allgemeintoleranzen fuer Nennmasse ohne Toleranz. General tolerances for nominal dimensions without specified tolerance.		

Nicht bemesszte Innenradien R = (2 ± 0.5)mm  
Undimensioned inner radii R = (2 ± 0.5)mm

Werkstückkanten und Oberfläche bitte gesondert anfragen.

Zust.	Änderung	Datum	Name	Masse (Kg/St.)	0,045	Oberfläche:		
						德国莫克有限公司 7015 钢条扣 Halter/bracket Z.-Nr.: B5723351L3		

